

SF1575F

GPS-Filter unbalanced / balanced

This product is lead-free in compliance with RoHs 2002/95/EC.

Test Conditions:

RF power	0 dBm	
Temperature	23 °C	
DC Voltage	0 V	
Terminating source impedance (Z_s)	50 Ω	unbalanced
Terminating load impedance (Z_L)	100 Ω	balanced

	minimum	typical	maximum	unit
Centre frequency		1575.42		MHz
Insertion Loss in Pass Band 1574.42 – 1576.42 MHz		1.2	1.7	dB
VSWR in Pass Band 1574.42 – 1576.42 MHz			1:1.8	
Rejection				
100 MHz – 1425 MHz	35	38		dB
1425 MHz – 1515 MHz	30	35		dB
1515 MHz – 1530 MHz	20	28		dB
1620 MHz – 1675 MHz	15	25		dB
1675 MHz – 1850 MHz	35	40		dB
Output phase balance	-15	0	15	°
Output amplitude balance	-1.0	0.2	1.0	dB
RF Power			22	dBm
Operating temperature range	-40		+85	°C
Storage temperature range	-40		+85	°C
Temperature coefficient of frequency		-31.0		ppm/K

Electrostatic Sensitive Device

Specification

Package: S23 / 3.0*3.0mm²

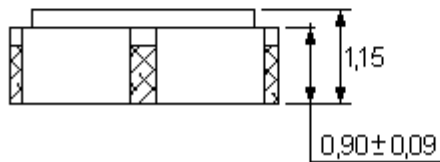
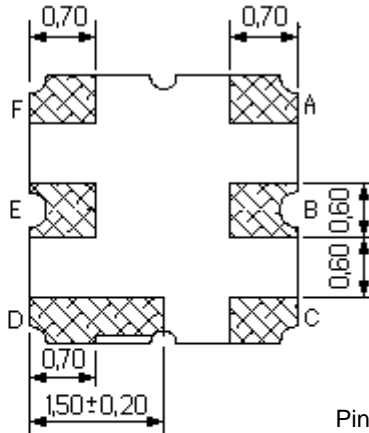
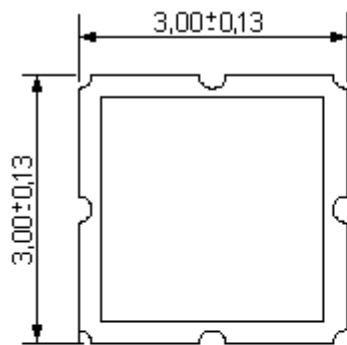

- Pin A +RF Out
- Pin B Output Ground
- Pin C -RF Out
- Pin D Input Ground
- Pin E RF In
- Pin F Input Ground

Typical performance:

